

Copyright Reserved
The Contractor shall verify and be responsible for all dimensions. DO NOT scale the drawing. Any errors or omissions shall be reported to Stantec, written daily. The Contractor shall design and construct at the safety of Stantec. Reproduction or use for any purpose other than that authorized by Stantec is forbidden.

Consultants
CIVIL: Kimley-Horn and Associates, Inc.
LANDSCAPE: Kimley-Horn and Associates, Inc.
SPORTS FIELD CONSULTANT: Sports Design Group
STRUCTURAL: Stantec
MEP: CM/A
AUDIOVISUAL: BA
FOOD SERVICE: Food Service Design Professionals

Kimley-Horn

© 2020 KIMLEY-HORN AND ASSOCIATES, INC.
TEXAS REGISTERED ENGINEERING FIRM F-928
11700 KATY FREEWAY, SUITE 800, HOUSTON, TX 77079
PHONE: 281-597-9300 WWW.KIMLEY-HORN.COM

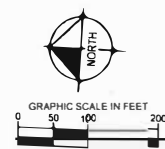

LEGEND	
	PROP. 7" CONCRETE DRIVE
	PROP. 6" CONCRETE PARKING LOT
	PROP. 4.5" CONCRETE SIDEWALK
	PROP. 4" CONCRETE SIDEWALK
	PROPERTY BOUNDARY
	PROP. SAWCUT
	PROP. EXPANSION JOINT
	PROP. PARKING CURB
	PROP. LIGHT POLE
	PROP. HANDICAP PARKING
	PROP. LIGHT STRUCTURE
	PROP. GATE
	PROP. HANDICAP RAMP
	PROP. STORM MANHOLE
	PROP. GRATE INLET
	PROP. CURB INLET
	PROP. SSWR MANHOLE
	PROP. FIRE HYDRANT
	PROP. WATER VALVE
	LIMITS OF CONSTRUCTION

- NOTES**
1. DIMENSIONS ARE TO FACE OF CURB UNLESS OTHERWISE NOTED.
 2. ALL RADII'S UNLESS OTHERWISE NOTED.
 3. REFER TO ARCHITECTURAL PLANS FOR SITE LIGHTING POLES AND FIXTURES AND ELECTRICAL PLAN PRIOR TO PLACING PAVEMENT.
 4. REFER TO ARCHITECTURAL PLANS FOR EXACT BUILDING DIMENSIONS.
 5. SIDEWALKS TO HAVE A 5% MAXIMUM RUNNING SLOPE AND A 2% MAXIMUM CROSS SLOPE IN ACCORDANCE WITH ADA REQUIREMENTS.
 6. FIELD VERIFY ADA GRADES PRIOR TO PLACING PAVEMENT. CONTRACTOR SHALL CONSTRUCT ALL ACCESSIBLE ROUTES IN ACCORDANCE WITH ADA STANDARDS AND TAS.
 7. REF. IRRIGATION PLANS PRIOR TO PLACING PAVEMENT.
 8. CONTRACTOR SHALL BUDGET FOR ACCESSIBLE STALL STRIPING, FIRE LANE STRIPING, DIRECTIONAL ARROWS, ETC.
 9. SITE LIGHTING IS BY OTHERS. REF. SITE LIGHTING PLANS FOR LOCATIONS AND DETAILS PRIOR TO PLACING PAVEMENT.
 10. REF. BUILDING PLANS FOR ALL EXTERIOR STAIR DETAILS.
 11. CONTRACTOR TO ADJUST EXISTING SANITARY MANHOLES, STORM SEWER MANHOLES, ELECTRICAL MANHOLES, FIRE HYDRANTS, VALVE BOXES, WATER METERS, ETC. TO MATCH PROPOSED FINISHED GRADED IF NECESSARY.

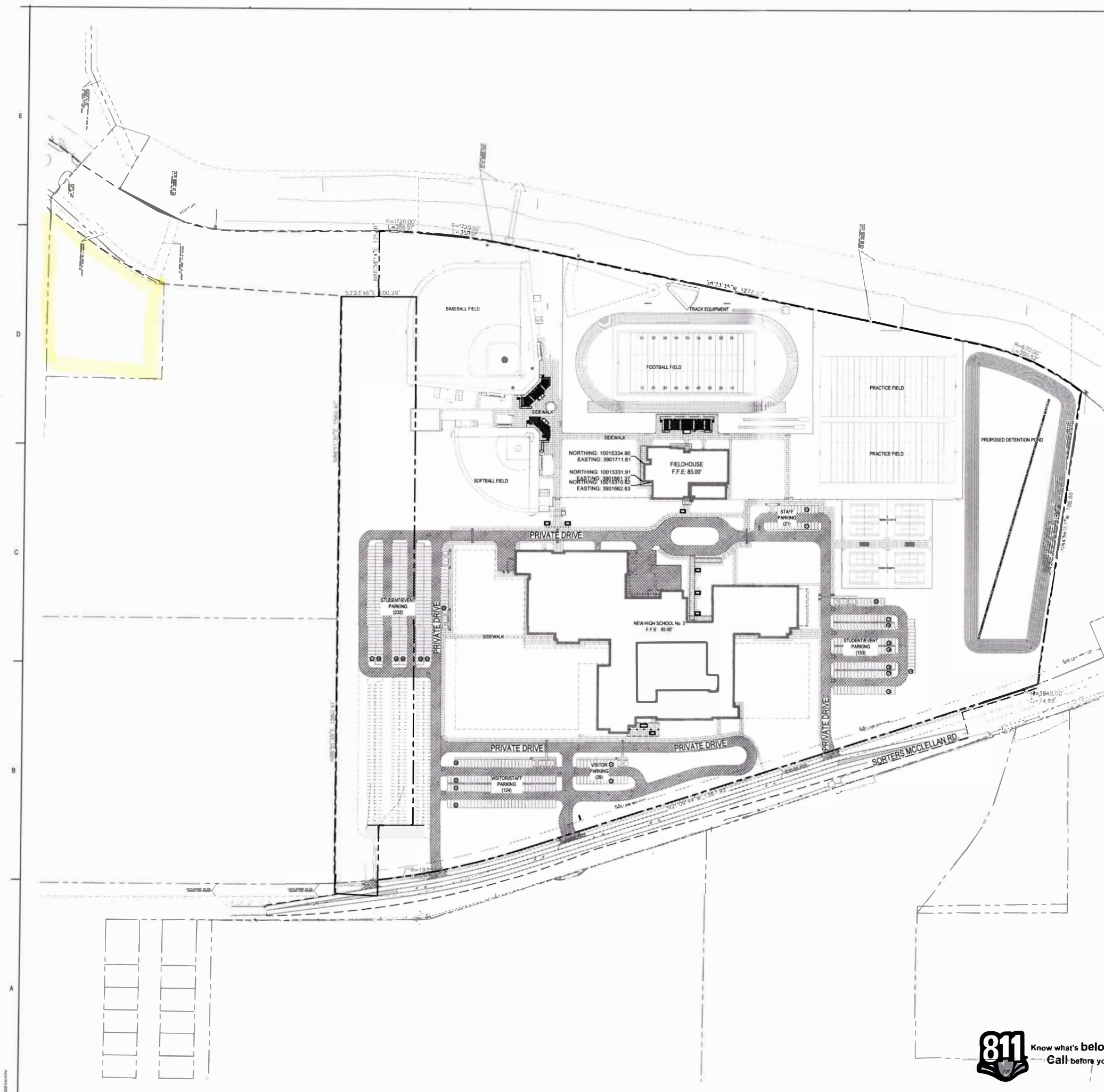

Revision	By	App'd	YYYY-MM-DD

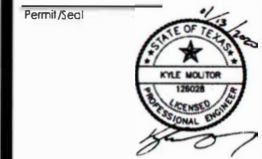

NEW CANEY ISD
Client/Project
New Caney Independent School District
New Comprehensive High School No. 3
180 Sorter McClellan Road
Kingwood, Texas 77339
Title
OVERALL SITE PLAN

Project No. 214000593	Scale
Revision	Drawing No. C4.0



CAUTION!
EXISTING UNDERGROUND UTILITIES IN THE AREA CONTRACTOR IS RESPONSIBLE FOR DETERMINING THE HORIZONTAL AND VERTICAL LOCATION OF ALL UTILITIES PRIOR TO CONSTRUCTION. CONTRACTOR SHALL BE RESPONSIBLE FOR ANY REPAIRS TO EXISTING UTILITIES DUE TO DAMAGE INCURRED DURING CONSTRUCTION. CONTRACTOR SHALL NOTIFY THE ENGINEER OF ANY DISCREPANCIES ON THE PLANS.